

PULLERS

W012 KTC MULTI PULLER SET- Japan

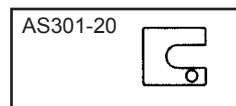
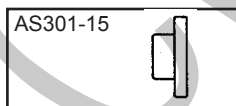
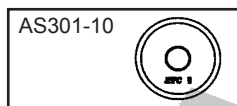
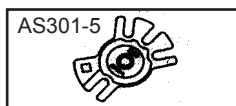
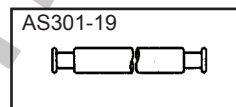
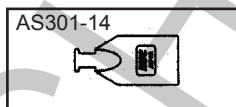
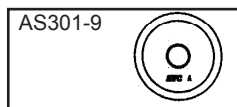
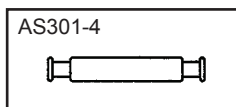
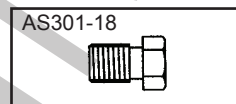
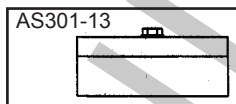
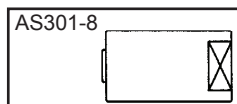
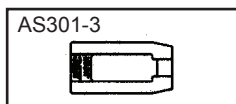
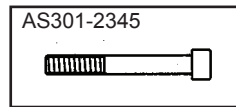
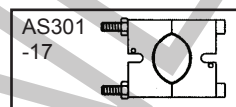
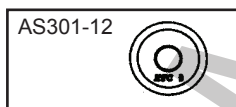
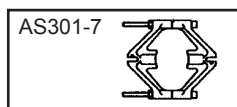
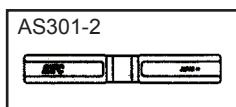
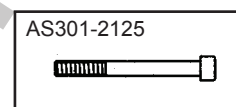
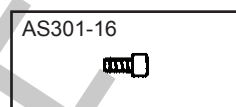
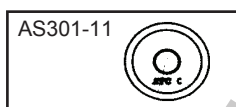
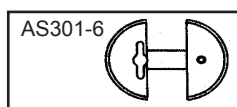
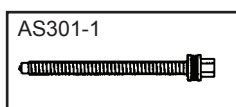
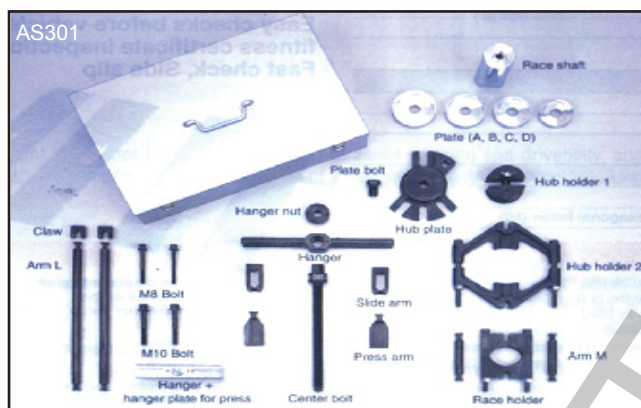

Stock No.	Item	Unit Price (set)
012-115-301	AS301	S\$ 1046.10
Contents: 1pc Center bolt assy. (AS301-1) 1pc Hanger (AS301-2) 1pc Slide arm (AS301-3) 2pcs Arm M (AS301-4) 1pc Hub plate (AS301-5) 1pc Hub holder 1 assy. (AS301-6) 1pc Hub holder 2 assy. (AS301-7) 1pc Race shaft (AS301-8) 1pc each - 4 types of Plate (AS301-9, 10, 11, 12) 1pc Hanger assy. for press (AS301-13) 2pcs Press arm (AS301-14) 1pc Hanger nut (AS301-15) 1pc Race holder assy. (AS301-17) 1pc Plate bolt (AS301-18) 2pcs Arm L (AS301-19) 2pcs Claw (AS301-20) 2pcs M8 Bolt (AS301-2125) 2pcs M10 Bolt (AS301-2345)		

Made of heat-treated carbon steel, for all Japan and European cars.